

**LEGEND**

	EXISTING PROPOSED ELEMENTS
	Infiltration Structure
	Catch Slices (10mm)
	EXISTING 11kV Cable
	EXISTING Post Top
	Development Boundary
	EXISTING 5kV LV Cable
	LV Cable
	EXISTING Meter Pit Mark
	EXTENSION 93 BOUNDARY
	TOWNSHIP BOUNDARY

3-1/2" x 11 1/2" V.A.  
5 x 500

WATERLOOF CORNWALL HILL SUPPLY AREA SYSTEM DIAGRAM

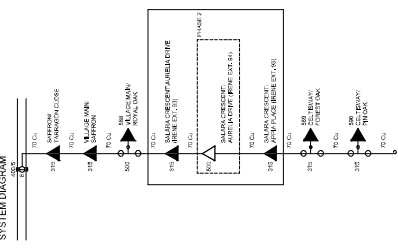

**INGPLAN**  
 ELECTRICAL ENGINEERS  
 1000 W. 10TH STREET, SUITE 100  
 WILMINGTON, DE 19804  
 TEL: 302.438.4388 FAX: 302.438.4387

DATE: 2012-06-23  
 DRAWING ISSUES:  
 PREPARED:   
 APPROVAL:   
 COORDINATION:   
 CONSTRUCTION:   
 AS BUILT:

DESIGNED BY	E. GENE D. EPP
DRAWN BY	A. BRASE
CHECKED BY	J.P. MILLER P. Eng.
DATE	2012-06-19
SCALE	1:500
PROJECT NO.	FA-1196
DRAWING NO.	98P10068
SHEET	1 of 1

**ELECTRICITY DIVISION**  
 GENERAL MANAGER  
 ELECTRICITY  
 J.A. CIRICH, P. Eng.  
 PO BOX 628  
 WILMINGTON, DE 19804  
 TEL: 302.438.4388 FAX: 302.438.4387

APPROVED BY  
 for Electricity Division  
 DATE: \_\_\_\_\_  
 SCALE: 1:500



No.	Date	Drawn	Requester	Checked	Electrical Development	Verification of connection point by Specialist Engineering: 11kV or LV	Date	Verification of electrical design by Specialist Engineering: Development	Date
A									
B									
C									
D									
E									

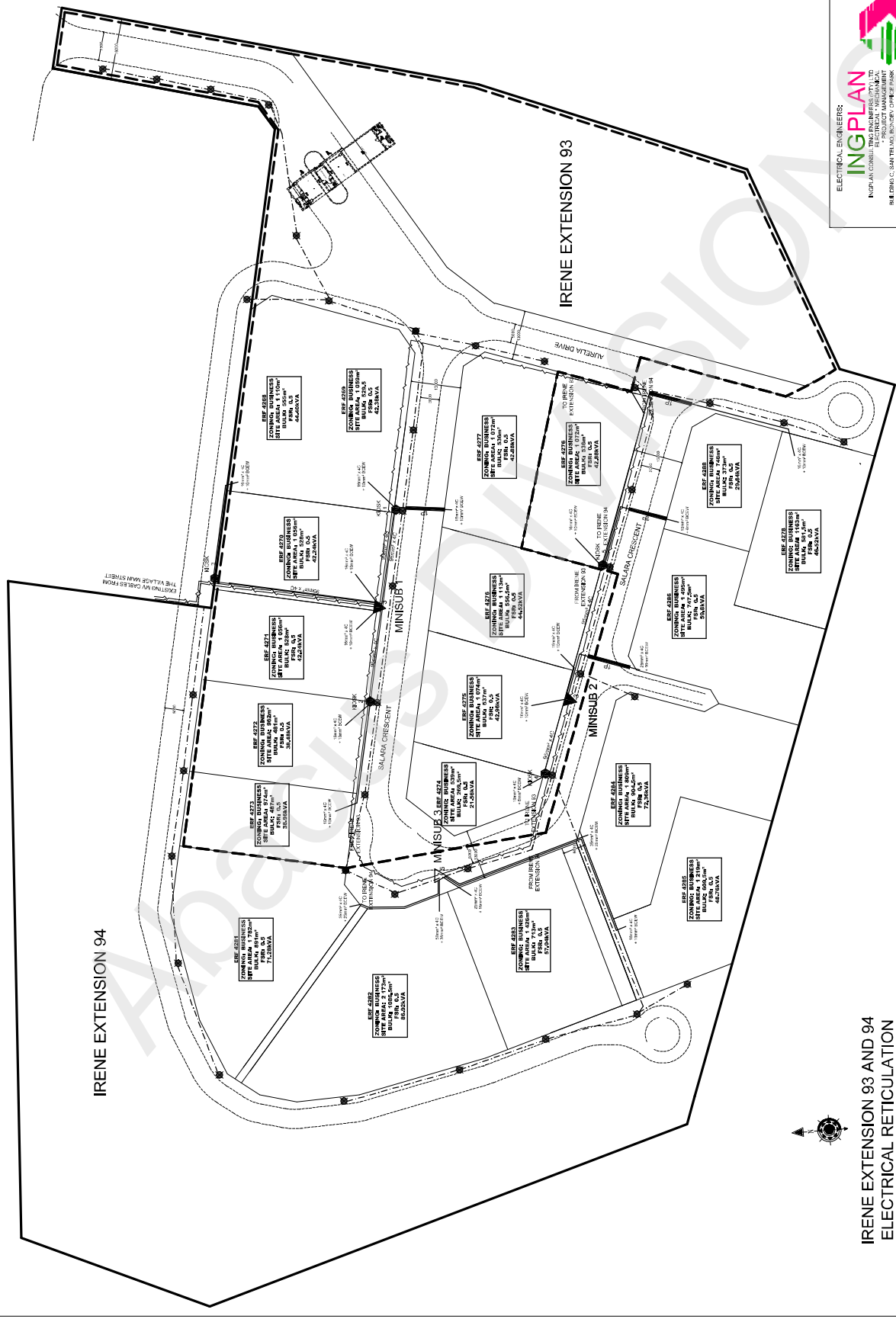

**IRENE EXTENSION 93 AND 94 ELECTRICAL RETICULATION**

